

Captive Socket Button Head Screws

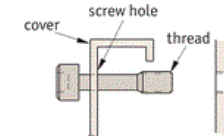
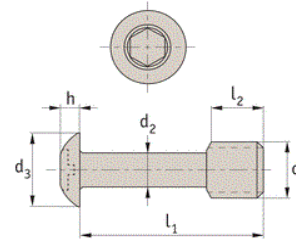

Screw The Captive Screw Through The Screw Hole In The Cover. When The Screw Is Been Removed From The Frame/Panel, The Screw Will Not Fall From The Cover Due To The Thread Catching Against The Screw Hole In The Cover. Often Used With A Captive Washer

Captive Socket Button Head Screws					
Diameter-d1	M2.5	M3	M4	M5	M6
d2 (+/-0.12)	1.7	2	2.8	3.7	4.2
L2 (+/- 0.25)	3.7	4.5	6	7.5	7.5
d3 Max	4.5	5.7	7.6	9.5	10.5
h Max	1.5	1.65	3.1	3.7	4.7
A/F	1.5	2	2.5	3	4
	Length - L1 (+/- 1.5mm)				
	8	10	12	12	16
	To	To	To	To	To
	20	40	60	60	80

Material: A2 Stainless Steel

INFORMATION AND DRAWINGS PROVIDED ARE FOR REFERENCE ONLY